

# COUNTERTOP FORM

Instruction Sheet

STEGMEIER  
LLC

www.stegmeier.com

There are many different ways to install pour in place concrete countertops. We will demonstrate a two inch counter (1 1/2" concrete, 1/2" decking) with a two inch overhang. This is one of the fastest and easiest ways to install counters. If you need more options, please call 1 800 382-5430.

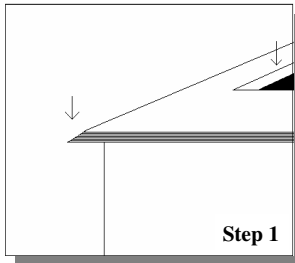

Step 1

**Step 1.** Use 1/2" or 3/4" decking. Cut the decking two inches longer than the outside edge of the counter, at a 45 degree angle. Cut the holes for the sink, stove top, refrigerator, and all other appliances at a 90 degree angle. Brace the cabinets if needed. Lay the decking on top of the cabinets. Fasten the decking down with wood screws.

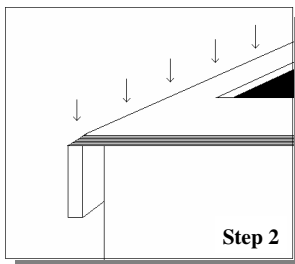

Step 2

**Step 2.** Hold (1x4) lumber flush to the tip of the 45 degree angle, and shoot brads straight down every 6 inches.

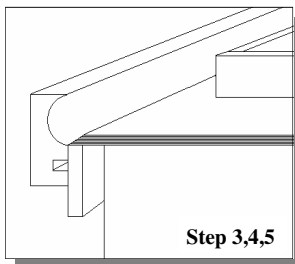

Step 3,4,5

**Step 3.** Peel the paper from the double faced tape (one foot at a time). Stick the form to the (1x4) with the bottom of the decorative profile edge level with the top of the (1x4).

**Step 4.** Run a strip of bending tape across the top lip of the form. To protect the form while screeding and finishing.

**Step 5.** Fasten (1x4) lumber in the sink, stove, and refrigerator cavities. PVC pipe can be used for the water lines. Use our form to get the level for the lumber and pipe.

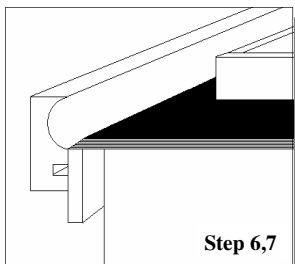

Step 6,7

**Step 6.** Get the level for the wall with our form. Pop a chalk line against the wall. Use masking tape on top of the chalk line to protect the wall's finish.

**Step 7.** Seal the plywood decking with plastic sheeting or a bonding agent. This will help prevent the decking from swelling.

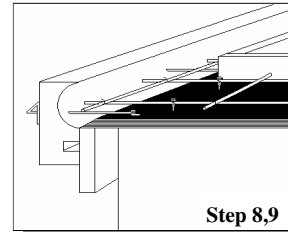

Step 8,9

**Step 8.** Drive screws provided, 5 inches from the form. Push a tie wire through the form even with the top of the decking. Hold the back of the form with slight pressure and wrap the tie wire around the screw. Use a tie wire every 15 inches.

**Step 9.** Drive woodscrews (halfway) into decking across the entire top. Lay wire mesh on screws and tie mesh to the screws with wire.

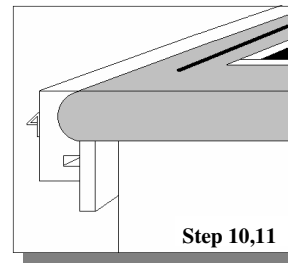

Step 10,11

**Note :** It helps to reinforce the corners with a upper and lower strip of bending tape on the backside of the form before pouring.

**Step 10.** While pouring tap the forms to release air bubbles. This will help prevent honeycombing.

**Step 11.** On the sink's edge, add a stick of rebar long enough so that it is 6" past the sink's corners. Press rebar into concrete 1 inch.

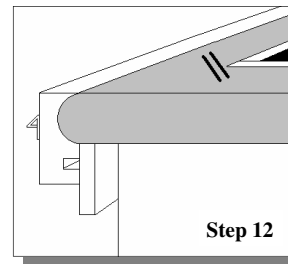

Step 12

**Step 12.** Add two 4" long pieces of rebar at each appliance corner. Press into concrete 1 inch. Finish the surface

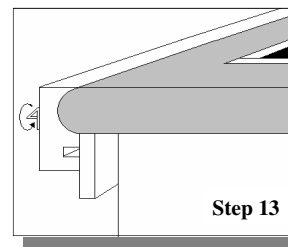

Step 13

**Step 13.** When the concrete is strong enough to support it's own weight, the forms can be removed. Twist the tie wire heads, the wire will break inside the concrete. Pull the form away to expose the face. Use the foam profile tool to get a clean sharp finish on the face.

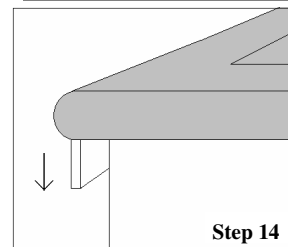

Step 14

**Step 14.** Remove the (1x4) lumber after 12 hours . Pull the lumber straight down. There will be brads left in the decking. They can be pulled (down) straight through the decking with pliers.

*Bending instructions are included in this box.  
Technical Support(800) 382-5430*